

## BT8852NS

| NO. | DESCRIPTION    | NO. | DESCRIPTION      | NO. | DESCRIPTION       |
|-----|----------------|-----|------------------|-----|-------------------|
| 1   | GEAR CASE ASSY | 31  | HARNESSESS CLAMP | 61  | HAND GRIP         |
| 2   | STOP RING      | 32  | CLAMP            | 62  | SPRING            |
| 3   | STOP RING      | 33  | SCREW M5X20      | 63  | BOX RIGHT         |
| 4   | BEARING 6000Z  | 34  | NUT M5           | 64  | SCREW ST2.9X18    |
| 5   | PINION         | 35  | CLUTCH COMP      | 65  | SCREW M5X30       |
| 6   | STEEL PLATE    | 36  | CLUTCH DRUM COMP | 66  | CABLE COMP        |
| 7   | CAPSCREW M5X20 | 37  | STOP RING        | 67  | TUBE              |
| 8   | WASHER         | 38  | BEARING 6202     | 68  | STOP BUTTON COMP  |
| 9   | SCREW M5X12    | 39  | STOP RING        | 69  | HAND GRIP         |
| 10  | BOLT M6X12     | 40  | UNKER            | 70  | SPRING            |
| 11  | WASHER         | 41  | RUBBER COVER     | 71  | BOX LEFT          |
| 12  | GEAR CASE      | 42  | SCREW M5X20      | 72  | NYLON CUTTER HAND |
| 13  | BLADE COVER    | 43  | SCREW M5X12      | 73  | CASE              |
| 14  | BEARING 6000Z  | 44  | STOP RING        | 74  | LEFT NUT          |
| 15  | GEAR           | 46  | CLAMP            | 75  | WASHER            |
| 16  | SHAFT          | 47  | WIRE CLAMP BAND  | 76  | SPRING            |
| 17  | BEARING6002    | 48  | HARNESSESS ASSY  | 77  | NYLON CORD        |
| 18  | STOP RING      | 49  | BOLT M5X25       | 78  | CORD HOLDER       |
| 19  | HOLDER         | 50  | CAPLOWER         | 79  | PLATEN            |
| 20  | HOLDER         | 51  | BRACKET          | 80  | COVER             |
| 21  | HOLDER         | 52  | HANDLE           | 81  | BRACKET           |
| 22  | LEFT NUT       | 53  | GRIP LEFT        | 82  | SCREW M5X30       |
| 24  | 40T BLADE      | 54  | CAP OPPER        | 83  | SAFETY GUARD      |
| 25  | PIPE COMP      | 55  | HANDLE           | 84  | WASHER            |
| 26  | RUBBER COVER   | 56  | LEVER ASSY       | 85  | SCREW M5X16       |
| 27  | OIL BEARING    | 57  | SCREW ST2.9X13   | 87  | GUARD             |
| 28  | DRIVE SHAFT    | 58  | BUTTON           | 88  | BLADE             |
| 29  | PIPE           | 59  | SPRING           | 89  | GUARD ASSY        |
| 30  | HOLDER ASSY    | 60  | CLOCK PIN        |     |                   |

BT8852NS-EX-XW2409RUS-STM037

Sturm!  
нас рекомендуют друзья

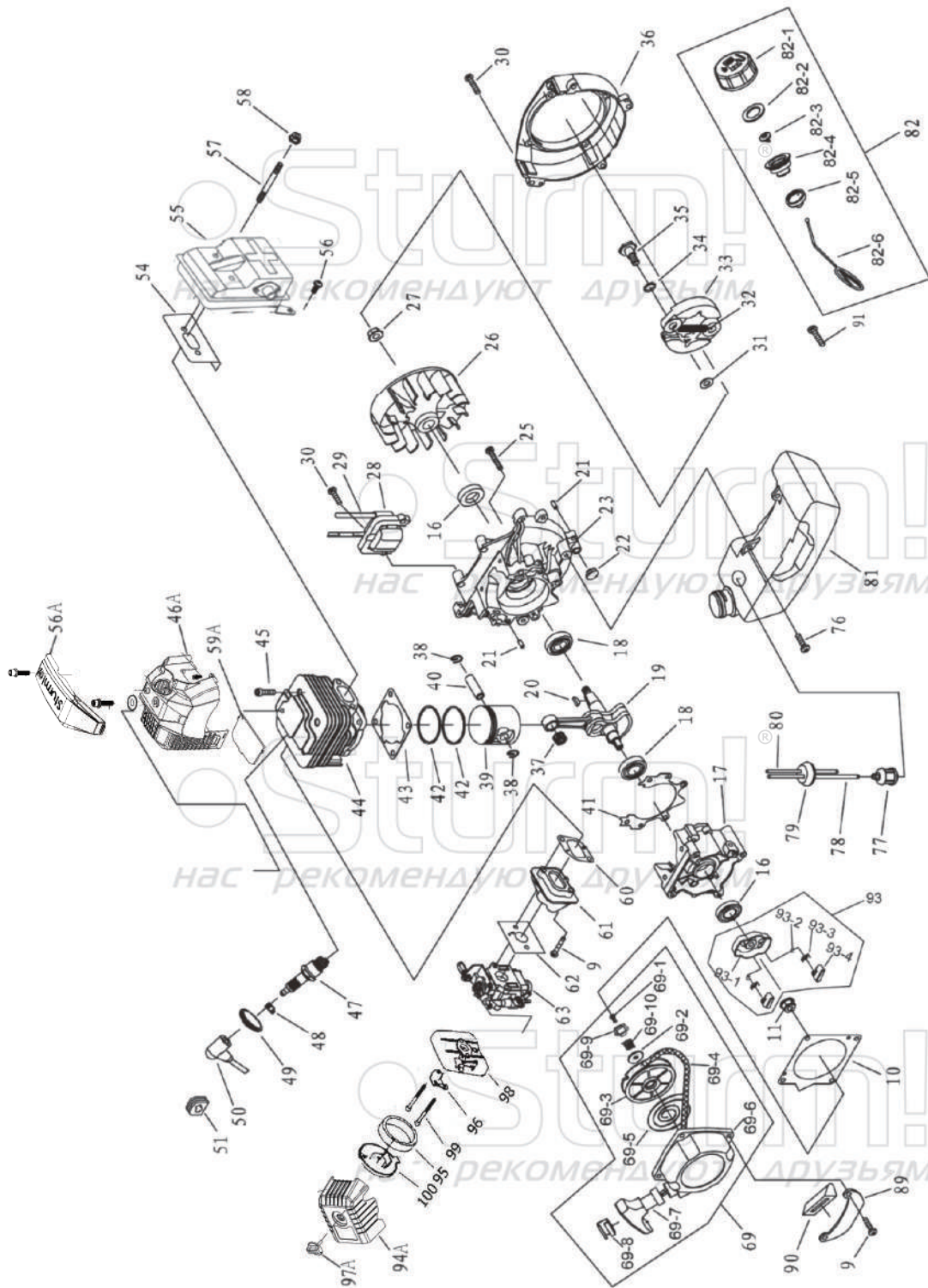

## ENGINE FOR BT8852NS

| NO. | DESCRIPTION        | NO.  | DESCRIPTION      | NO.   | DESCRIPTION            |
|-----|--------------------|------|------------------|-------|------------------------|
| 9   | SCREW M5X20        | 44   | CYLINDER         | 69-10 | EASY START COIL SPRING |
| 10  | GASKET             | 45   | SCREW            | 76    | SCREW M5X16            |
| 11  | NUT                | 46A  | GUIDE COVER ASSY | 77    | CLEANER COVER          |
| 16  | OIL SEAL           | 47   | SPARK PLUG       | 78    | OUTLET FUEL PIPE       |
| 17  | CRANK CASE         | 48   | SPRING           | 79    | PLUG                   |
| 18  | BEARING 6202       | 49   | PLUG COVER       | 80    | INLET FUEL PIPE        |
| 19  | CRANKSHAFT         | 50   | PLUG CAP         | 81    | FUEL TANK              |
| 20  | KEY                | 51   | PLUG             | 82    | LID ASSY               |
| 21  | PIN                | 54   | GASKET           | 82-1  | FUEL TANK LID          |
| 22  | RUBBER WASHER      | 55   | MUFFLER          | 82-2  | GASKET                 |
| 23  | CRANK CASE         | 56A  | TOP COVER        | 82-3  | INLET                  |
| 25  | SCREW M5X30        | 57   | BOLT             | 82-4  | INSIDE COVER           |
| 26  | MAGNETO ROTOR COMP | 58   | NUT              | 82-5  | LID                    |
| 27  | NUT                | 59A  | WIND DEFLECTOR   | 82-6  | CHAIN                  |
| 28  | IGNITION COLL COMP | 60   | GASKET           | 89    | STAND                  |
| 29  | CORD COMP          | 61   | ADMITTING PIPE   | 90    | RUBBER COVER           |
| 30  | BOLT M5X20         | 62   | GASKET           | 91    | SCREW M5X20            |
| 31  | WASHER             | 63   | CARBURETOR       | 93    | STARTER PULLEY ASSY    |
| 32  | SPRING             | 69   | STARTER          | 93-1  | STARTER REEL           |
| 33  | EXPANDER           | 69-1 | SCREW            | 93-2  | STOP RING              |
| 34  | WASHER             | 69-2 | WASHER           | 93-3  | STARTER PAWL SPRING    |
| 35  | SCREW PIN          | 69-3 | START POPE REEL  | 93-4  | STARTER PAWL           |
| 36  | FAN COVER          | 69-4 | POPE             | 95    | SPONGE                 |
| 37  | BEARING 10X13X16   | 69-5 | RECOIL SPRING    | 96    | HASP                   |
| 38  | RING               | 69-6 | START COVER ASSY | 99    | SCREW                  |
| 39  | PISTON             | 69-7 | START HANDLE     | 100   | CIRCULAR COVER         |
| 40  | PISTON PIN         | 69-8 | RING             | 94A   | AIR FILTER COVRER      |
| 41  | GASKET             | 69-9 | START RATCHET    | 97A   | SCREW NUT              |
| 42  | PISTON RING        |      |                  | 98    | CARBURETOR HOLDER      |
| 43  | GASKET             |      |                  |       |                        |

BT8852NS-EX-XW2409RUS-STM037

**Sturm!**  
нас рекомендуют друзья